

# ECOFLOW

## EcoFlow DELTA 2 Max User Manual

V1.0

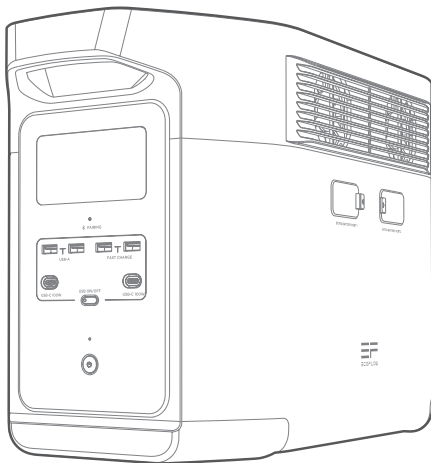

# Disclaimer

Before using this product, please read and fully understand this document and all related documents of this product. After reading this document, please keep it well for future reference. Failure to properly operate this product could cause serious injury to yourself or others, or damage to this product and other property. By using this product, you are deemed to have understood, acknowledged and accepted all terms and contents of this document. The user undertakes to be responsible for his/her actions and all consequences arising therefrom. EcoFlow is not liable for all losses caused by the user's failure to use this product according to the disclaimer and safety instructions.

EcoFlow reserves the right of final interpretation of this document and all related documents of this product where permitted by laws and regulations. These documents are subject to update, revision or termination from time to time without prior notice, please visit EcoFlow website for the latest product information.

# Content

<b>Specifications</b>	1
<b>Safety Instructions</b>	2
<b>EcoFlow App</b>	4
<b>What's in the Box</b>	4
<b>Product Details</b>	6
Overview	6
LCD screen	7
<b>Power On/Off</b>	8
<b>Charge Your Devices</b>	8
<b>Charge DELTA 2 Max</b>	9
AC Charging	9
Solar Charging	10
Car Outlet Charging	11
Smart Extra Battery	11
<b>X-Boost and EPS</b>	12
X-Boost	12
EPS	12
<b>FAQ</b>	13
<b>Storage and Maintenance</b>	13
<b>Troubleshooting</b>	14

# Specifications

General Info	
Model	EFD350
Weight	Approximately 23 kg (50 lbs)
Dimension	497 × 242 × 305 mm (19.6 × 9.5 × 12 in)
Capacity	2,048Wh
Bluetooth	Frequency range: 2,402-2,480 MHz Maximum output power: (US) 0.005W; (CA) 0.012W
Wi-Fi	Frequency range: 2,412-2,462 MHz/2,422-2,452 MHz Maximum output power: (US) 0.071W; (CA) 0.177W
Output Ports	
AC (×6)	Pure sine wave, 2,400W total (surge 4,800W) 120V~ 50/60Hz
AC (bypass mode)	100-120V~ max. 15A 50Hz/60Hz (Duration time <3 hours when current exceeds total 12 A)
Max X-Boost Output Power	3,400 W
USB-A (×2)	5V ≐ 2.4A, max. 12W per port, total 24W
USB-A Fast Charging (×2)	5V ≐ 2.4A 9V ≐ 2A 12V ≐ 1.5A, max. 18W per port, total 36W
USB-C (×2)	5/9/12/15/20V ≐ 5A, max. 100W per port, total 200W
Car Outlet	12.6V ≐ 10A, max. max. 126W
DC5521 Output (×2)	12.6V ≐ 3A, max. 38W per port
Input Ports	
AC input power	X-Stream max. 1,800W 15A
AC input voltage	100-120V~ max. 15A 50Hz/60Hz
Solar charging input (×2)	11-60V ≐ 15A, single port 500W; dual port 1,000W
Car charger	Supports 12V/24V battery, default 8A
Battery Info	
Battery type	LFP
Cycle life	3,000 cycles to 80% + capacity
Protection type	Over Voltage Protection, Overload Protection, Over Temperature Protection, Short Circuit Protection, Low Temperature Protection, Low Voltage Protection, Overcurrent Protection

Operating Temperature	
Optimal operating temperature	20°C to 30°C (68°F to 86°F)
Discharging temperature	-10°C to 45°C (14°F to 113°F)
Charging temperature	0°C to 45°C (32°F to 113°F)
Storage temperature	-10°C to 45°C (14°F to 113°F) (optimal: 20°C to 30°C (68°F to 86°F))
Add-ons	
Smart extra battery	Up to 2 units (sold separately)
Smart generator	Supported (sold separately)



1. A car charger shares power with the DC5521 output port, offering a maximum output of 126W.
2. Whether the product can be charged or discharged depends on the actual temperature of the battery pack.



## Safety Instructions

### Warning

1. Please read all the instructions carefully before using the product.
2. Do not use the product near a heat source, such as a fire source or a heating furnace.
3. Avoid contact with liquids of any kind. Do not use the product in the rain or in high humidity.
4. Do not put fingers or hands into the product.
5. Do not operate the power pack with a damaged cord or plug, or a damaged output cable.
6. Do not use the product around strong static electricity or magnetic fields.
7. Do not disassemble in any way or puncture the product with sharp objects.
8. To reduce the risk of damage to the electric plug and cord, pull the plug rather than the cord when disconnecting the power pack.
9. This product must be grounded. If it should malfunction or breakdown, grounding provides a path of least resistance for electric current to reduce the risk of electric shock. This product is equipped with a cord having an equipment grounding conductor and a grounding plug. The plug must be plugged into an outlet that is properly installed and grounded in accordance with all local codes and ordinances.
10. Users should not place the product on the floor, or at a height less than 457 mm (18 inches) above the floor, during use in a repair facility.
11. Do not use a battery pack or appliance that is damaged or modified. Damaged or modified batteries may exhibit unpredictable behavior resulting in fire, explosion or risk of injury.
12. Do not disassemble the power pack, take it to a qualified service person when service or repair is required. Incorrect reassembly may result in a risk of fire or electric shock.
13. Avoid using wires or metal objects that may result in a short circuit.

14. Do not use unofficial components or accessories to avoid the risk of fire, electric shock or injury to persons. If you need to replace any components or accessories, please visit official EcoFlow channels for relevant information.
15. When using the product, please strictly follow the operating environment temperature specified in this user manual. If the temperature is too high, it may result in a fire or explosion; if the temperature is too low, the product performance may be severely reduced, or the product may cease to work.
16. Do not stack any heavy objects on the product.
17. Do not lock the fan forcibly during use when charging the internal battery, work in a well ventilated area and do not restrict ventilation in any way.
18. To reduce the risk of electric shock, unplug the power pack from the outlet before attempting any instructed servicing.
19. Have servicing performed by a qualified repair person using only identical replacement parts. This will ensure that the safety of the product is maintained.
20. Ensure the product is not hit, dropped, or heavily vibrated. Securely fasten the product when transporting it to avoid damage. If the product is severely damaged, turn off the power source immediately and discontinue using the product.
21. If you accidentally drop the product into water during use, please place it in a safe open area, and stay away from it until it is completely dry. The dried product should not be used again, and should be properly disposed of according to the "Disposal Guide" below. If the product catches fire, we recommend that you use the fire extinguishers in the following order: water or water mist, sand, fire blanket, dry powder, and finally a carbon dioxide fire extinguisher.
22. Clean the product ports with a dry cloth.
23. Place on a flat surface to keep the product from falling over. If the product is overturned and severely damaged, turn it off immediately, place the battery in an open area, keep it away from people and combustible matter, and dispose of it in accordance with local laws and regulations
24. To reduce the risk of injury, close supervision is necessary when the product is used near children.
25. Store the product in a dry and ventilated place.
26. We recommend that you use moisture barrier bags in wet environments (for example, places by the sea or waterways) to prevent the product from getting soaked. If water is found inside the product, it must not be used or turned on again. Please take anti-electric shock measures before touching the product. Following this, place the product in a safe, waterproof and open area. Once complete contact EcoFlow Customer Service immediately.
27. This product is not recommended for powering medical emergency equipment related to personal safety, including but not limited to medical grade ventilators (hospital version CPAP: Continuous Positive Airway Pressure), artificial lungs (ECMO, Extracorporeal Membrane Please follow your doctor's instructions and consult with the manufacturer for restrictions on the use of the equipment. If used for general medical equipment, please be sure to monitor the power status to ensure that the power does not run out.
28. When in use, power supply products will generate electromagnetic fields, which are likely to affect the normal operation of medical implants or personal medical equipment such as pacemakers, cochlear implants, hearing aids, defibrillators etc. If these types of medical equipment are being used, please contact the manufacturer to inquire about any restrictions on the use of such equipment. These measures are fundamental to ensure a safe distance between the medical implants (for example, pacemakers, cochlear implants, hearing aids, defibrillators etc.) and this product while in use.

29. When the power supply is connected in normal mode to a refrigerator, power fluctuations may cause the power supply to shut down automatically. When connecting the power supply to a refrigerator that stores medicine, vaccines or other valuable items, it is recommended to set the AC output to "Always on" in the app. This helps support a continuous power supply and ensures a safe and efficient power consumption state.
30. SAVE THESE INSTRUCTIONS

## Disposal Guide

1. If conditions permit, make sure that the battery is fully discharged before disposing of it in a designated battery recycling bin. The product contains batteries with potentially dangerous chemicals, so it is strictly prohibited to dispose of it in ordinary trash cans. For more details, please follow the local laws and regulations on battery recycling and disposal.
2. If the battery cannot be fully discharged due to product failure, please do not dispose of the product directly in the battery recycling box, instead, contact a professional battery recycling company for further processing.
3. Please dispose of over-discharged batteries that cannot be recharged.

## EcoFlow App

Control, monitor and customize your EcoFlow DELTA 2 Max from afar with the EcoFlow App.  
Download at: <https://download.ecoflow.com/app>



### Privacy policy

By using EcoFlow Products, Applications and Services, you consent to the EcoFlow Term of Use and Privacy Policy, which you can access via the "About" section of the "User" page on the EcoFlow App or on the official EcoFlow website at

<https://www.ecoflow.com/policy/terms-of-use>

and

<https://www.ecoflow.com/policy/privacy-policy>

# What's in the Box

---

DELTA 2 Max



---

AC charging cable

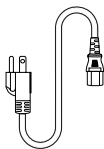

---

Car charging cable

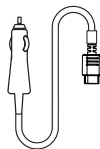

---

DC5521 to DC5525 Cable

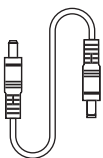

---

User manual & warranty card

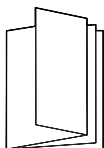



# Product Details

## Overview

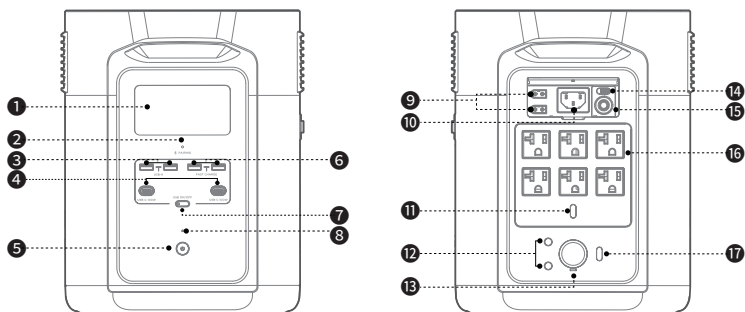

- |                                |                                    |                                |
|--------------------------------|------------------------------------|--------------------------------|
| 1. LCD screen                  | 6. USB-A fast charging output port | 13. Car outlet port            |
| 2. Bluetooth pairing indicator | 7. USB power button                | 14. AC charging speed switch   |
| 3. USB-A output port           | 8. Main power indicator            | 15. Overload protection switch |
| 4. USB-C output port           | 9. Solar/car charging input port   | 16. AC output sockets          |
| 5. Main power button           | 10. X-Stream charging input port   | 17. 12V DC power button        |
|                                | 11. AC power button                |                                |
|                                | 12. DC5521 output port             |                                |

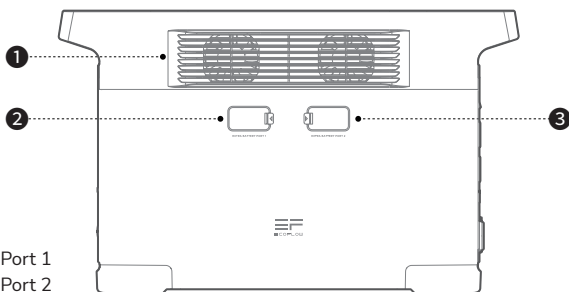

1. Ventilator
2. Extra Battery Port 1
3. Extra Battery Port 2

## LCD Screen

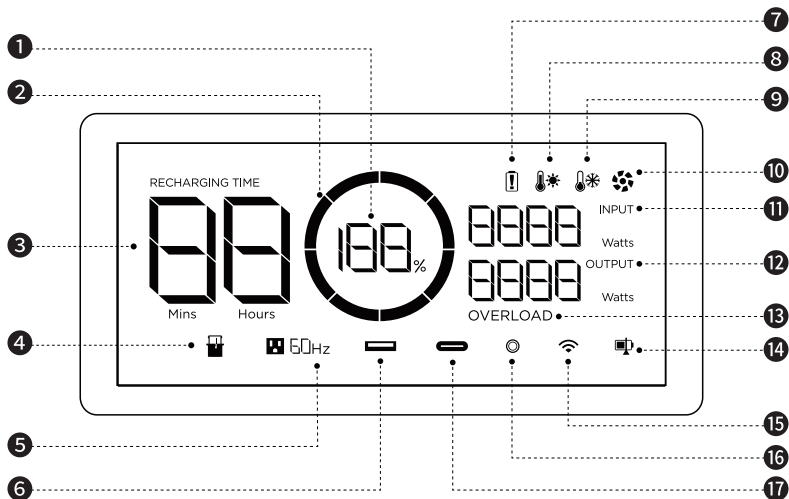

- |   |                             |                      |
|---|-----------------------------|----------------------|
| 1. Remaining battery percentage         | 5. AC output                | 11. Input power      |
| 2. Battery level                        | 6. USB-A Output             | 12. Output power     |
| 3. Remaining charging/ discharging time | 7. Battery failure warning  | 13. Overload warning |
| 4. Extra battery                        | 8. High temperature warning | 14. State of charge  |
|   | 9. Low temperature warning  | 15. Wi-Fi status     |
|   | 10. Fan                     | 16. 12V DC output    |
|   |                             | 17. USB-C output     |

Icon	Name	State
	Remaining battery percentage	Rotating clockwise: charging 100%: fully charged Flashing: flat battery
	Wi-Fi	Solid: Internet connection succeeded Off: Internet connection failed



Refer to "Troubleshooting" for details.

# Power On/Off

Press the main power button once to turn on the product, then the LCD screen lights up and the main power indicator becomes breathing white; press and hold the main power button for at least 3 seconds to turn off the product, meanwhile, the LCD screen goes off.

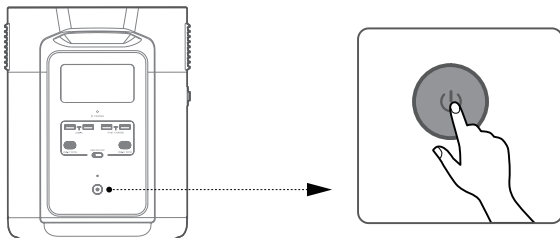

1. After main power turned on, press the main power button once to turn off the LCD screen
2. If the product is not used for 5 minutes, it will enter hibernation state with the LCD screen gone off. When you start to use the product again, the LCD screen will turn on automatically.
3. The product defaults to 2 hours of standby time. With the output power buttons turned off and no other load for 2 hours, the product will shut off automatically. You can set the standby duration in the app.

# Charge Your Devices

After the product is turned on, press "USB power button", "12V DC power button" or "AC power button" once to turn on their corresponding USB/DC/AC ports or sockets; press again to turn them off.

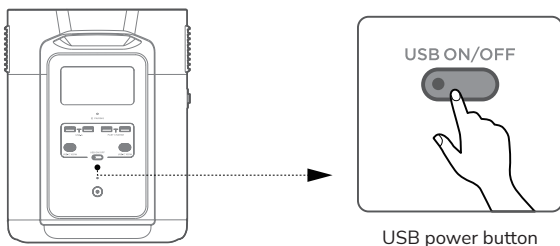

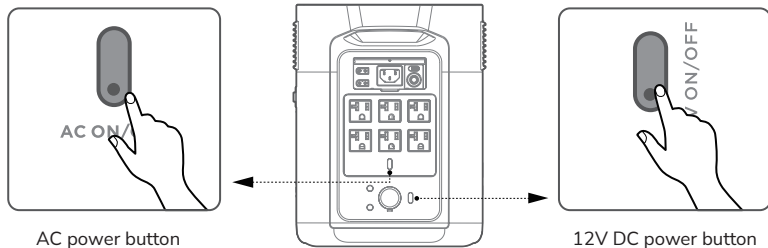

1. After the USB or DC power button is turned on, the product will not shut off automatically.
2. Make sure that the total power of all loaded devices is lower than that of the rated power.
3. After 12 hours without any load for the AC output ports, the AC power button will shut down automatically.

## Charge DELTA 2 Max

### AC Charging

EcoFlow's X-Stream fast charging technology is specifically designed for AC charging. The AC charging speed can be adjusted via the EcoFlow app. In case of unusual situations where the AC input current remains higher than 20A, the X-Stream charging input port will initiate a self-protection function, and the Overload Protection Switch on the product will automatically pop up. After confirming that there is no product failure, you can press the Overload Protection Switch to resume charging.

About 80 minutes

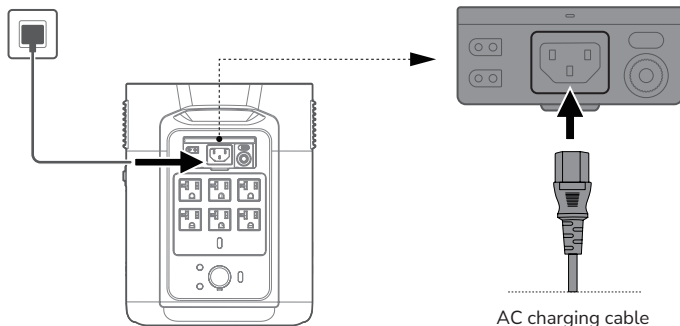

The charging power can be adjusted through the AC Charging Speed Switch. You can set the charging power range in the EcoFlow App.

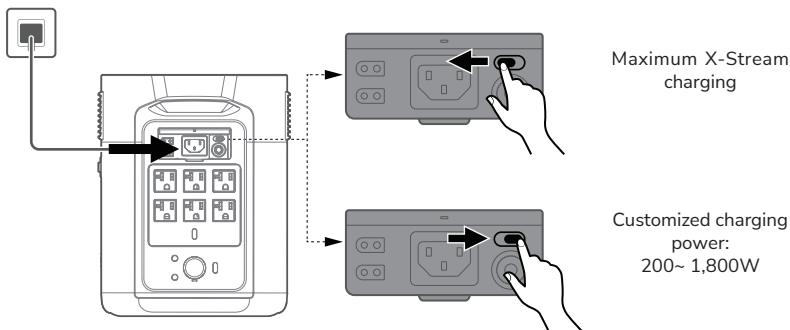

1. Please use the AC Charging Cable included in the package for fast charging. Do not use other cables to charge.
2. Plug directly into an AC wall outlet and make sure that the wall output current is more than 15A. Otherwise, reduce the unit charging speed with the AC Charge Speed Switch. EcoFlow takes no responsibilities for any consequences caused by failures to follow instructions, including but not limited to charging with other AC charging cables.

## Solar Charging

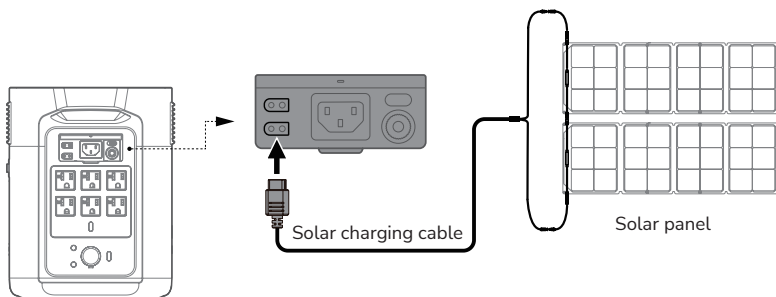

1. Solar charging cable (MC4-XT60 adapter cable) and the solar panel are supplied separately.
2. When using an EcoFlow solar panel to charge the product, please follow the instructions that come with the solar panel.
3. Before connecting the solar panel, please ensure that the solar panel's output voltage is within 60V to avoid product damages.

## Car Charging

To avoid failure to start due to insufficient car battery, use the car charger after the vehicle is started. In addition, please make sure that the cigarette lighter of the Car Outlet and the Car Charger Input Cable are in good condition. EcoFlow takes no responsibilities for any losses or damages caused by failures to follow instructions

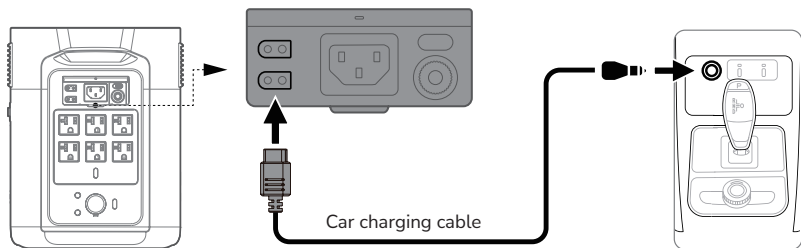

## Smart Extra Battery

A single DELTA 2 Max can connect up to 2 Smart Extra Battery for additional capacity. Please check the user manual of DELTA 2 Max Smart Extra Battery for more information.

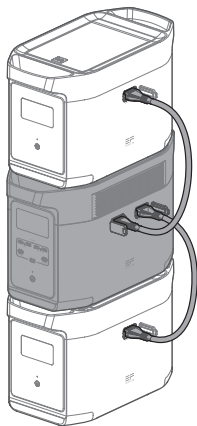

1. Turn off both the Smart Extra Battery and DELTA 2 Max before connecting or disconnecting them.
2. Before using, make sure both DELTA 2 Max and Smart Extra Battery display the extra battery icon on their screens.
3. Do not directly connect or remove the Smart Extra Battery during charging and discharging processes. If you need to connect or remove it midway, please turn off the product first.
4. Do not touch the metal terminals of the Smart Extra Battery connector. If the metal terminals need to be cleaned, gently wipe them with a dry cloth.

# X-Boost and EPS

## X-Boost

To avoid operation failure due to overload protection, the X-Boost feature will be automatically enabled when the total output exceeds the rated output power, which enables the product to power high wattage appliances at the rated output power.

1. X-Boost is not available when the AC output is turned on in a recharging state (in bypass mode).
2. X-Boost is enabled by default, you can adjust it in the EcoFlow App.
3. X-Boost is not available for all electrical appliances; it's incompatible with appliances with strict voltage requirements. Appliances with voltage protection (such as precise instruments) are not supported. X-Boost mode is more suitable for heating devices. Please conduct your own tests with your devices with X-Boost enabled.



**Bypass mode:** When the product is plugged into the power socket for recharging and connected to other devices at the same time, it cannot provide power to the devices if the AC power button is turned on, instead, the devices are powered by the grid.

## EPS (Emergency Power Supply)

The product supports EPS. When you connect the grid power to the AC Input Port of the product through an AC cable, you can power electrical devices through the AC Output Port (AC power will come from the grid and not the power station in this situation). In case of a sudden blackout, the product can automatically switch to the battery powered supply mode within 30ms.



As a basic UPS function, this function does not support 0ms switching. Please do not connect the product to any device that requires 0ms UPS, such as data servers and workstations. Please test and confirm the compatibility before using the product. We recommend that you only charge one device at a time and avoid using multiple ones at the same time to avoid overload protection. EcoFlow takes no responsibilities for any device failures or data losses caused by failures to follow instructions.

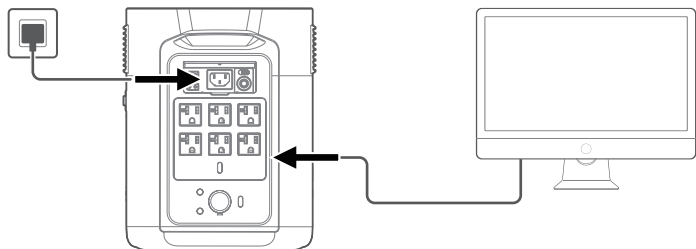

# FAQ

## 1. What battery does the product use?

High-quality LFP battery.

## 2. What devices can the product's AC output port power?

With high rated power and peak power, the product's AC output port can power most household appliances. Before you use it, we recommend that you confirm the power of the appliances first and ensure the power sum of all loaded appliances is lower than the rated power.

## 3. How long can the product charge my devices?

The charging time is shown on the product's LCD Screen, which can be used to estimate the charging time of most appliances with stable power usage.

## 4. How do I know if the product is charging?

When it's charging, the remaining charging time will be shown on the LCD Screen. Meanwhile, the charging indicator icon begins to rotate with the remaining battery percentage and the input power shown on the right of the circle.

## 5. How do I clean the product?

Gently wipe it with a dry, soft, clean cloth or paper towel.

## 6. How do I store the product?

Before storing, please turn off the product first, and then store it in a dry and ventilated place at room temperature. Do not place it near water sources. For long-term storage, please discharge and recharge the product every three months to extend its battery life.

## 7. Can I bring the product on a plane?













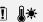

No.

# Storage and Maintenance

1. Ideally, use and store the product in a place of between 20°C ~ 30°C (68°F ~ 86°F), and always keep it away from water, intense heat, and sharp objects. For an extended product lifespan, do not store it in places above 45°C (113°F) or below -10°C (14°F).
2. For long-term storage, please discharge the product every three months (firstly discharge it to 0%, then fully recharge it, and lastly discharge it to 60%); the product will not be covered by the warranty if it is not charged or discharged for more than 6 months.

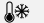

# Troubleshooting

Indicator	Problem	Solution
 OVERLOAD (Flashing)	USB-A Overload Protection	Resume normal operation by removing the electrical device connected to the USB-A port.
 OVERLOAD (Flashing)	USB-C Overload Protection	Resume normal operation by removing the electrical device connected to the USB-C port.
RECHARGING TIME  (Flashing)	High Temperature Charging Protection	Charging will resume automatically once the battery cools down.
 (Flashing)	High Temperature Discharging Protection	The power supply will resume automatically once the battery cools down.
RECHARGING TIME  (Flashing)	Low Temperature Charging Protection	Charging will resume automatically once battery temperature rises above 5°C (41°F).
 (Flashing)	Low Temperature Discharging Protection	The power supply will resume automatically once the battery temperature rises above -12°C (10°F).
 50Hz OVERLOAD (Flashing)	AC Output Overload Protection	Normal operation will resume automatically once you remove the overloaded device and restart the product. Electrical appliances should be used within rated power. (Refer to X-Boost instructions to get more details about power limitations).
 50Hz  (Flashing)	AC High Temperature Protection	Please confirm whether the fan inlet and outlet are blocked, if not, normal operation will be resumed automatically after the product temperature drops.
 50Hz  (Flashing)	AC Low Temperature Protection	Normal operation will resume automatically once the product is used at optimum environmental temperatures.
 (Flashing)	Fan Blockage	Please check if the fan is blocked by foreign materials.
 OVERLOAD (Flashing)	Car Charger Overload Protection	The product will resume normal operation automatically after you remove the device connected to the car charger.
 (Flashing)	Car Charger High Temperature Protection	After the product cools down, it will resume normal operation automatically.
 (Stays on)	Battery Failure	Contact EcoFlow customer service.



If the Alarm Prompt shows on the product LCD screen during use and does not disappear after a restart, please stop using it immediately (do not try to charge or discharge). If you require any other assistance, please contact EcoFlow Customer Service.

# FCC Warning

This device complies with part 15 of the FCC Rules. Operation is subject to the following two conditions: (1) This device may not cause harmful interference, and (2) this device must accept any interference received, including interference that may cause undesired operation.

Any Changes or modifications not expressly approved by the party responsible for compliance could void the user's authority to operate the equipment.

**Note:** This equipment has been tested and found to comply with the limits for a Class B digital device, pursuant to part 15 of the FCC Rules. These limits are designed to provide reasonable protection against harmful interference in a residential installation. This equipment generates uses and can radiate radio frequency energy and, if not installed and used in accordance with the instructions, may cause harmful interference to radio communications. However, there is no guarantee that interference will not occur in a particular installation. If this equipment does cause harmful interference to radio or television reception, which can be determined by turning the equipment off and on, the user is encouraged to try to correct the interference by one or more of the following measures:

- Reorient or relocate the receiving antenna.
- Increase the separation between the equipment and receiver.
- Connect the equipment into an outlet on a circuit different from that to which the receiver is connected.
- Consult the dealer or an experienced radio/TV technician for help.

This equipment complies with FCC radiation exposure limits set forth for an uncontrolled environment.

This equipment should be installed and operated with minimum distance 20cm between the radiator & your body.

# IC Warning

This device complies with Industry Canada licence-exempt RSS standard(s).

Operation is subject to the following two conditions:

- (1) this device may not cause interference, and
- (2) this device must accept any interference, including interference that may cause undesired operation of the device.

Le présent appareil est conforme aux CNR d'Industrie Canada applicables aux appareils radio exempts de licence. L'exploitation est autorisée aux deux conditions suivantes:

- (1) l'appareil n' doit pas produire de brouillage, et
- (2) l'utilisateur de l'appareil doit accepter tout brouillage radioélectrique subi, même si le brouillage est susceptible d'en compromettre le fonctionnement.

This Class B digital apparatus complies with Canadian ICES-003.

Cet appareil numérique de la classe B est conforme à la norme NMB-003 du Canada.

IC RF Statement:

When using the product, maintain a distance of 20cm from the body to ensure compliance with RF exposure requirements.

≡COFLOW