

DIMENSIONS RAIL ALU 35X40 MM

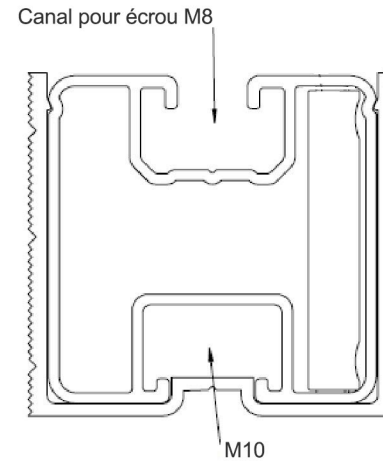

m'	0.780 kg/m
I _{xx}	56268 mm ⁴
I _{xy}	0 mm ⁴
I _{yy}	54418 mm ⁴
I _{yx}	0 mm ⁴
I _x	56268 mm ⁴
I _y	54418 mm ⁴
φ	0 Grad
W _p	110687 mm ⁴
A	288.5 mm ²
S _x /S _y	0 mm / 20.4 mm

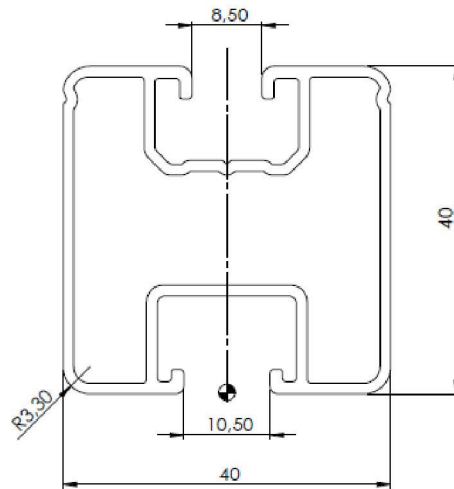