

1. Interface Layout

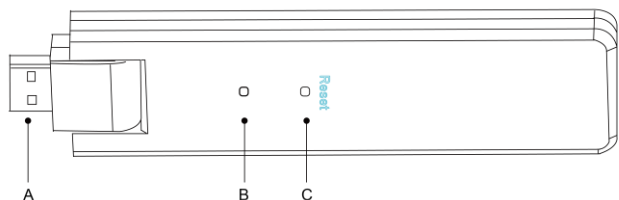

Item	Description
A	USB Connector
B	Status Indicator
C	Reset Button

2. Preparation

- A) Download the Hoy Miles mobile installer App



- B) Check the box for the following items:

✓ Hoy Miles DTU-WLite

3. Installation

- A) Power the DTU- WLite

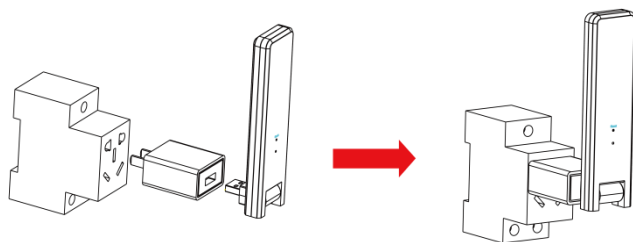

Option 2: Connect the DTU to the adapter and plug it into the Power Strip. Please make sure it is placed at least 0.5 meter above the ground and try to install the DTU

90 degrees vertical to the ground as much as possible.

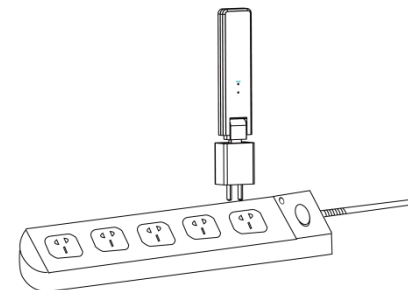

Note: Please do not install the DTU directly above the metal or concrete to prevent the signal dilution.

- B) Start Procedure
Once the DTU powers on, the red, green and blue lights will flash for one second in turns for 30 seconds.
- C) Set up with Internet
Use the smart phone/tablet open the Installer App and login. Approach to "O&M" on the bottom of the page and then "Network Configuration". And complete the Wi-Fi configuration.

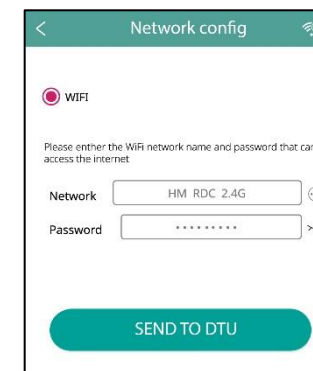
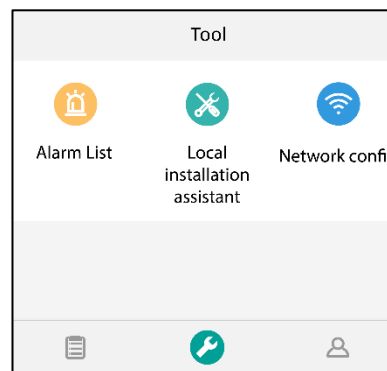

4. Installation Map

Please complete the installation map.

- A) Peel the serial number label (as circled below) from the DTU and place it on the installation map.

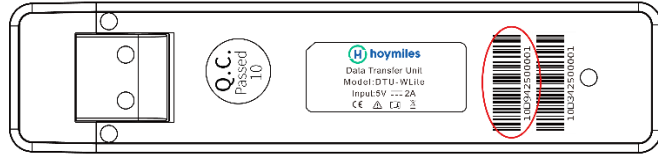

B) Complete system information of the installation map shown as follows.

To sheet _____ ↓

hoymiles		Hoymiles Microinverter Installation Map										APM0028 V1.2					
Please Make It For North		Panel type: Address: TIC: Sheet ___ of ___			Customer Information						DTU Serial Number:						
↑		1	2	3	4	5	6	7	8	9	10	11	12	13	14	15	16
↓		A															
		B															
		C															
		D															

↑ To sheet _____

↓ To sheet _____

5. Online Setting

Please complete the online account creation to complete the DTU installation (You can refer to “Quick Installation Guide for HMP Online Registration” for detail account creation steps).

Note: For more setting details regarding the Local Install Assistant please acquire the related Operation Guide from our Tech. Support Team at service@hoymiles.com.

6. Warning



- Only qualified personnel can install or replace the DTU.
- Do not attempt to repair the DTU as it contains the parts that are not serviceable to users. If the DTU breaks down, please contact your distributor for maintenance. Open the DTU without permission will invalidate the warranty.

